

# Straight Extended Pin Lever Care Handle

Chrome

Product Code: 133330

## Product Specifications

<b>Finish</b>	Chrome
<b>Materials</b>	Zinc handle
<b>Handle Reach</b>	153mm
<b>Suits</b>	35mm cartridge mixers
<b>Design</b>	Lever handle for care facilities or those with restricted movement.
<b>Inclusions</b>	Handle Hot & Cold indicator Warm & Cold indicator
<b>Maintenance and Care Instructions</b>	Clean using a soft sponge or cloth with warm soapy water or detergent. Never use abrasive brushes or scourer pads to clean products. Rinse with water immediately after using any cleaning solution.

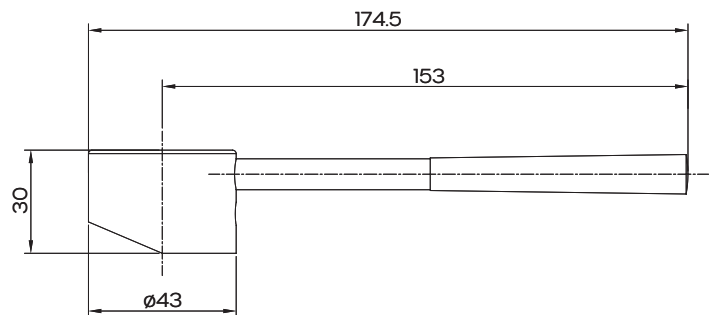
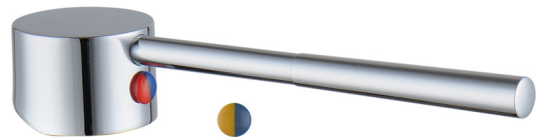

**Limited Warranty**  
(visit [raymor.com.au](http://raymor.com.au) for full warranty details)

For more information call 1800 729 667 or visit [raymor.com.au](http://raymor.com.au)

© Registered trademark of Tradelink. All dimensions given are approximate and should be checked prior to installation. See [raymor.com.au](http://raymor.com.au) for full warranty details.

**Raymor**<sup>®</sup>