

Opal Shower Bracket With Air Shower II

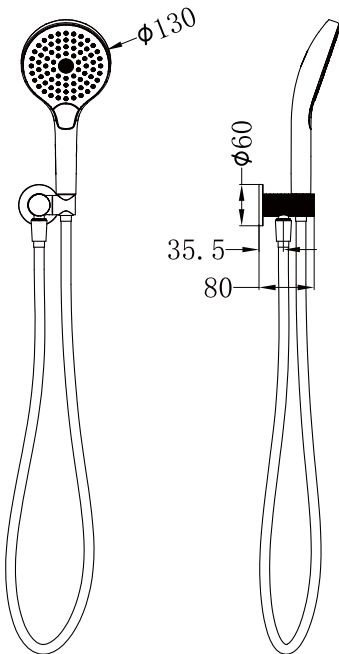





Dimensions are nominal measurements only.

SPECIFICATION

WELS RATING	3 STAR 9L/MIN
WATERMARK LICENSE	WM-060073
TEMPERATURE RATING	MIN 1°C-MAX 75°C
PRESSURE RATING	MIN 150KPa-MAX 500KPa

AVAILABLE FINISH

	BRUSHED NICKEL NR251905fBN		GRAPHITE NR251909fGR
	BRUSHED GOLD NR251905fBG		BRUSHED BRONZE NR251905fBZ

MAINTENANCE AND CARE

All surfaces should be cleaned with mild liquid detergent or soap and water.

Do not use cream cleaners or citrus based cleaning products, as they are abrasive.

Use of unsuitable cleaning agents may damage the surface. Any damage caused in this way will not be covered by warranty.

PACKING INCLUDES

- 1x hand shower (built-in check valve)
- 1x shower bracket
- 1x 1.5m PVC hose



Versions: V1

Important

All products must be installed by licensed plumbers.

All pipework must be thoroughly flushed prior to installation, as foreign materials may block the flow regulating device and reduce the flow of water.



1. Apply thread sealant or teflon tape on outlet thread.

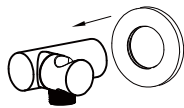

2. Pull back plate on together with bracket body.



3. Screw shower bracket body on to outlet. **DO NOT OVERTIGHTEN.** Slide the back plate against the wall/tile face properly.

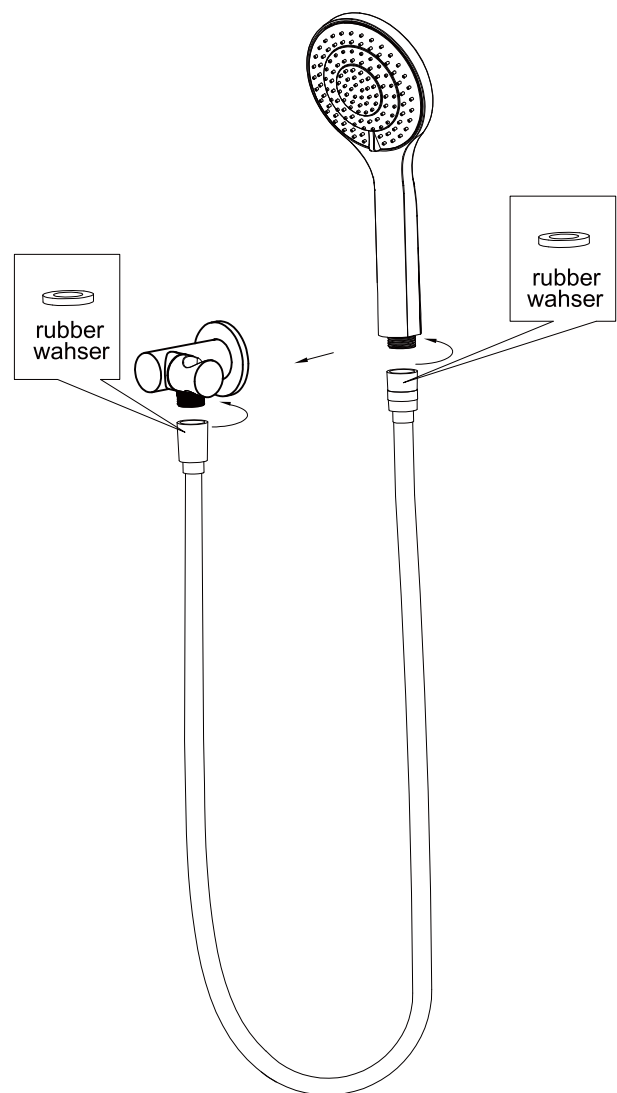

4. Connect bracket and hand shower with hose. **TEST & CHECK FOR LEAKS.**