

Edge II Basin Mixer Tower Brushed Nickel.

Product Code: 285890

Product Specifications.

WELS rating	WELS 5 Star 6.0L/min
Warranty	20 years - Mixer Cartridge, Body, Aerator, Hoses, Spout, Handle and Chrome Finish 10 years - Handpieces and pull-down hoses 5 years - PVD and Electroplate finishes 1 year - Seals and Labour
Colour	Brushed Nickel
Finish	Electroplating
Material	Lead Free Brass
Mount Type	Hob mount
Spout Reach	170mm
Spout Height	250mm
Swivel	No



Cartridge & Operation	35mm ceramic disc
Connector Tails	Nylon braided PERT lined hoses
Handle Style	Paddle
Recommended Operating Pressure	150/500kpa
Inclusions	Tower Mixer Installation instructions
Maintenance & Care	Clean using a soft sponge or cloth with warm soapy water or detergent. Never use abrasive brushes or scourer pads to clean products. Rinse with water immediately after using any cleaning solution

For more information call 1800 BATHROOM (1800 228 476) or visit raymor.com.au

© Registered trademark of Tradelink. All dimensions are in millimetres. Dimensions are approximate and should be checked against the physical product before installation. Changes may be made to this specification without notice due to our commitment to continual improvement. See raymor.com.au for full warranty details.

All dimensions in mm.

Version 1

raymor

Edge II Basin Mixer Tower Brushed Nickel.

Product Code: 285890

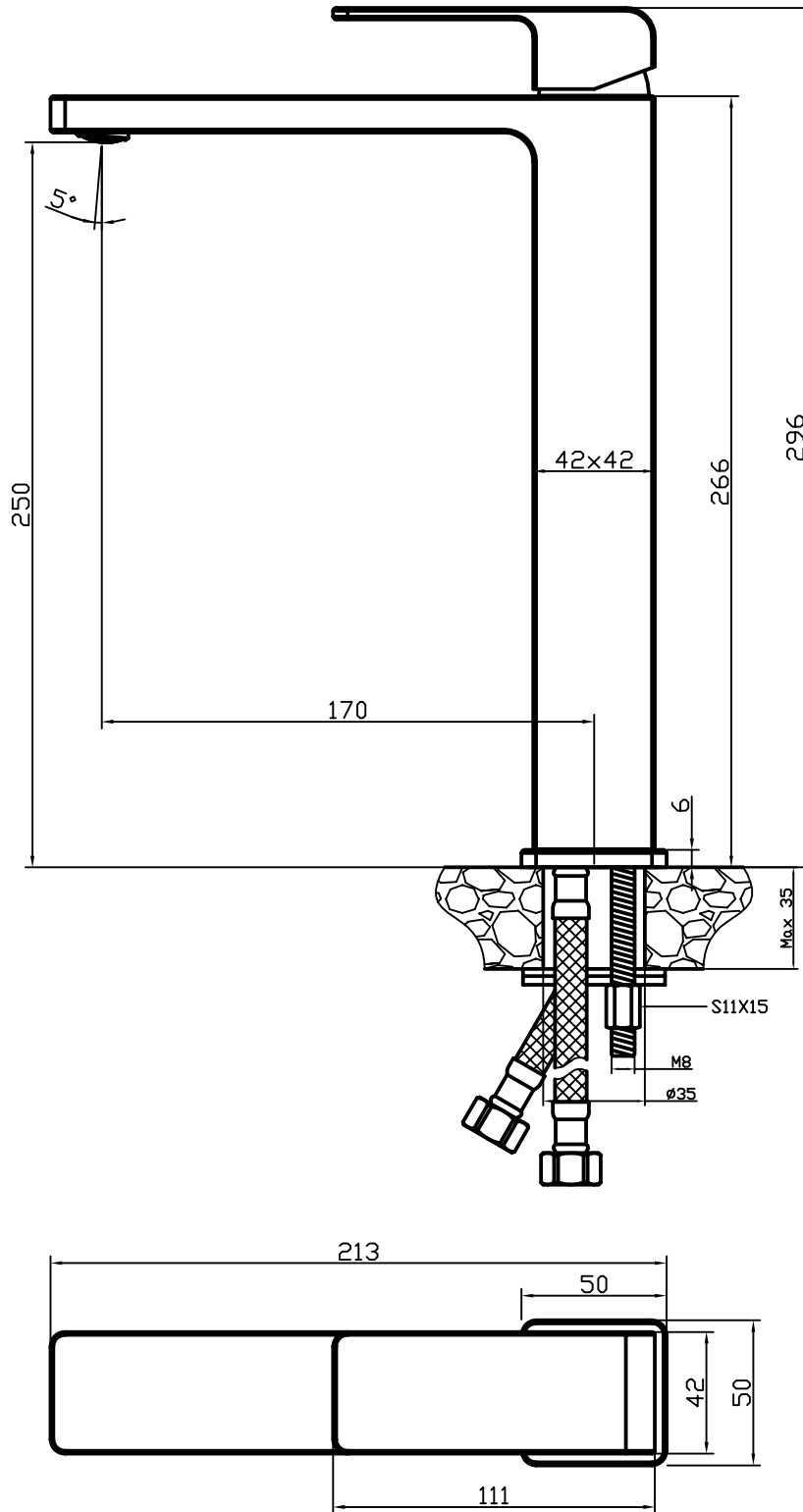

For more information call 1800 BATHROOM (1800 228 476) or visit raymor.com.au

© Registered trademark of Tradelink. All dimensions are in millimetres. Dimensions are approximate and should be checked against the physical product before installation. Changes may be made to this specification without notice due to our commitment to continual improvement. See raymor.com.au for full warranty details.
All dimensions in mm.

Version 1

raymor