

Over-Panel Glass To Glass Fitting 10mm Glass

Nero

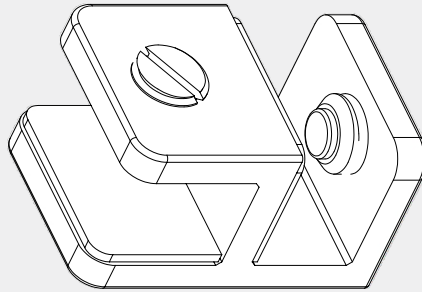

Versions:202401



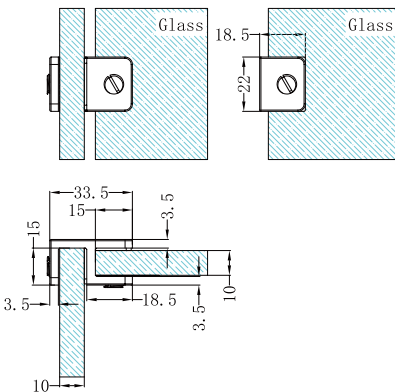



Drawing



Specifications

1. 90 degree glass to glass fixing bracket.
2. Use to fixing glass.
3. Suitable for 10mm glass.
4. Manufactured from high quality brass.

Finish & SKU

- | | | |
|---|--|--|
|  Chrome
NRSH201aCH |  Gun Metal
NRSH201aGM |  Brushed Bronze
NRSH201aBZ |
|  Matte Black
NRSH201aMB |  Brushed Gold
NRSH201aBG |  Brushed Nickel
NRSH201aBN |

*Dimensions are nominal measurements only.

INSTALLATION STEPS

Step 1: Use force slotted screwdriver to loosen the screws.

Step 2: Insert to glass, then lock the screws.

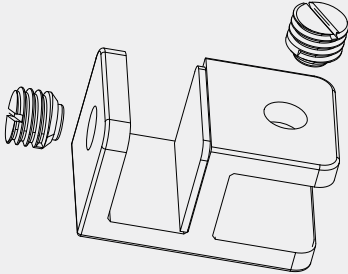

step 1

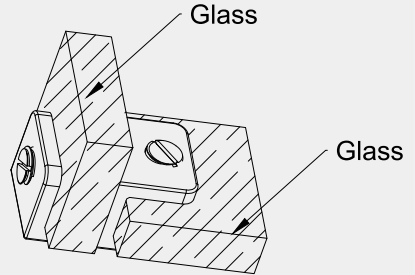

step 2

MAINTENANCE AND CARE

All surfaces should be cleaned with mild liquid detergent or soap and water.

Do not use cream cleaners or citrus based cleaning products, as they are abrasive.

Use of unsuitable cleaning agents may damage the surface.

Any damage caused in this way will not be covered by warranty.

NOTE:

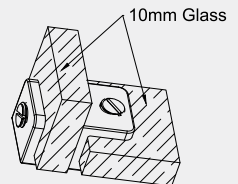

Only use for 10mm glass

Nero