

CAROMA LIANO II - INTEGRATED BASIN HAND TOWEL RAIL

INSTALLATION INSTRUCTIONS

Important Information

- * Do not use hand towel rail for personal support.
- * This integrated towel rail is compatible with Liano II hand WB (code: 853010W)

Installation

- 1) Insert each metal toggle (1) through the hole under the basin as shown in **Fig. 1**.
- 2) Realign handles (2) and pull them outwards while pushing locking bush (3) towards the basin hole as shown in **Fig. 2**.
- 3) Break off handles (1) flush with locking bush (3) as shown in **Fig. 3**.
Trim excess with a pair of side cutter if required.
- 4) Fit gaskets (4) below the towel rail posts (5) as shown in **Fig. 5**.
- 5) Align holes in the gasket with screw holes in locking bush (3) installed in the basin, fit towel rail assembly (5) together with gaskets (4) under the basin then insert screws into locking bush screw holes and tighten, **DO NOT OVERTIGHTEN**, overtightening the screws may crack the basin.

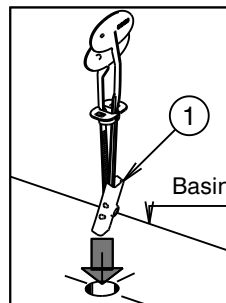

Fig. 1

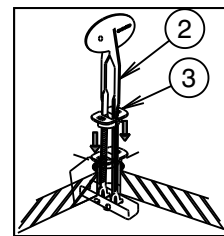

Fig. 2

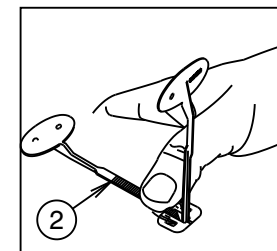

Fig. 3

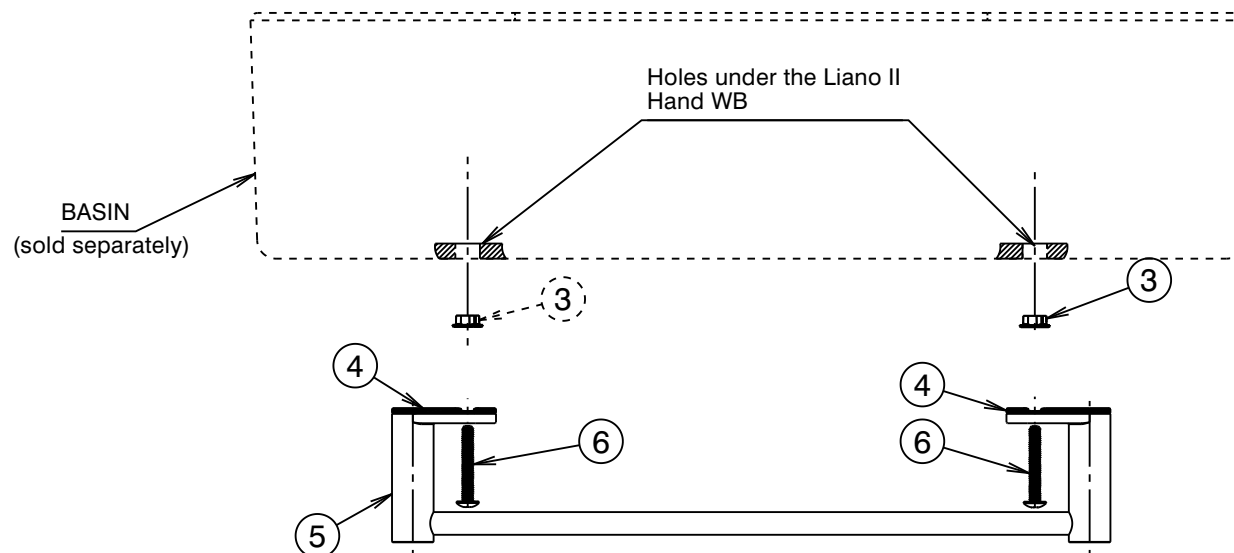

Fig. 4