

CAROMA LIANO II- RAIL SHOWER WITH OVERHEAD

PLUMBERS INSTALLATION INSTRUCTIONS

Important

- * Overhead shower (1) and Hand Shower (5) are fitted with flow regulators (2) and (6). This lower flow rate may not be suitable for connection to some gravity fed Water Heaters, low pressure supply networks, Instantaneous Water Heaters, Tempering Valves, Solar Water Heaters & Thermostatic Mixing Valves. Check with the manufacturers of these products.
Note: Warranty is void if flow regulators (2) and (6) are not installed as shown.
- * Not suitable for gravity feed systems.
- * All pipework must be thoroughly flushed prior to installation, as foreign materials may block the flow regulating device and reduce the flow of water.
- * **SHOWER RAIL (12) MUST NOT BE USED AS A GRAB RAIL.**
- * Centre of drilled hole for attachment of shower rail mounting post (17) must be vertically in alignment with the centre of the threaded nipple (16).
- * Where showers incorporate flow controllers care must be exercised during installation to ensure that the male connecting threads do not damage flow controllers.

Installation

- 1) Check that threaded nipple (16) is the correct length as shown. Cut to length if required ensuring end face is square. Apply thread tape to the thread.
Important: Care must be taken that thread tape cannot become dislodged and block the flow regulating devices, causing a reduction in water flow.
- 2) Screw adaptor (14) onto threaded nipple (16) until adaptor (14) is held securely against wall/tile face. **DO NOT OVERTIGHTEN.** Apply suitable lubricant to 'O'Rings on adaptor (14).
- 3) Mark the position for the shower rail mounting post (17) at a suitable distance from the threaded nipple (16). (Fig 1.)
- 4) **SOLID WALLS:-** (Brick, masonry blocks, concrete etc)
 - i) Drill hole 6.00mm diameter, 40mm deep.
 - ii) Insert tapered end of wall plug (20) into drilled hole and tap until flush with surface.
- 5) **CAVITY WALLS:-** (Villaboard/tile etc)
 - i) Drill hole 6.00mm diameter.
 - ii) Insert tapered end of wall plug (20) into drilled hole and tap until flush with surface.
- 5) Pass the screw (18) through the hole in mounting flange (19) and insert into wall plug (20), then tighten until the flange (19) is mounted securely against the wall/tile face.
- 6) Ensure screws (13) and (21) are unscrewed out in the diverter body (15) and mounting post (17). Slide the hand shower holder (27) onto the rail (12) and position it to be on the left or right of the shower rail as desired then lock in position by

IMPORTANT

Pressure & Temperature Requirements.

- Hot and cold water inlet pressures should be equal.
- Static inlet pressure range : 150 - 1000 kPa
New Regulation :-500 kPa maximum static pressure at any outlet within a building. (Ref. AS/NZS 3500.1)
- Maximum hot water temperature : 70°C.

Installation Requirements.

- The installing plumber is responsible for waterproofing all penetrations for Taps in Shower areas at installation by a proprietary flange system or a sealant. (Ref AS3740)

turning the lever. Slide the mounting post (17) over the rail (12) with the screw (21) underneath then carefully guide the rail assembly onto the spigot of adaptor (14) and mounting flange (19), taking care not to damage the 'O'Rings on the spigot. While holding the assembly against the wall, tighten the grub screws (13) & (21) using the 2.5mm allen key (11).

- 7) Ensure the check valves (8) and strainer (7) are fitted into housing (28), check that rubber washer (23) is installed into the shorter conical fitting (24) of shower hose (25) then screw onto thread end (22) of check valve housing (28) and tighten. Ensure washer (9) is fitted into the longer conical end (26) of shower hose (25), then screw onto handshower (5) and tighten. Fit handshower (5) into holder (27).
Note: Spray pattern can be adjusted by turning head of handset (5). Height of hand shower (5) can be adjusted by loosening lever on holder (27) and sliding the holder up or down.
- 8) Lubricate the 'O'rings on the spigot of diverter valve (15), wind out the screw (10) in shower arm (4), then install shower arm (4) onto spigot as shown. Tighten screw (10) using 2.5mm allen key (11) then, if required, back off 1/2 turn to allow the arm to swivel. Ensure flow regulator (2) and strainer washer (3) are installed in shower head (1). Carefully screw shower head (1) onto thread of shower arm (4) using a 22mm spanner & tighten. **Note:** To deliver water to the shower head (1), lever on diverter (15) must be pointing up. To deliver water to the hand shower (5), the lever must be rotated clockwise 90° to the stop.

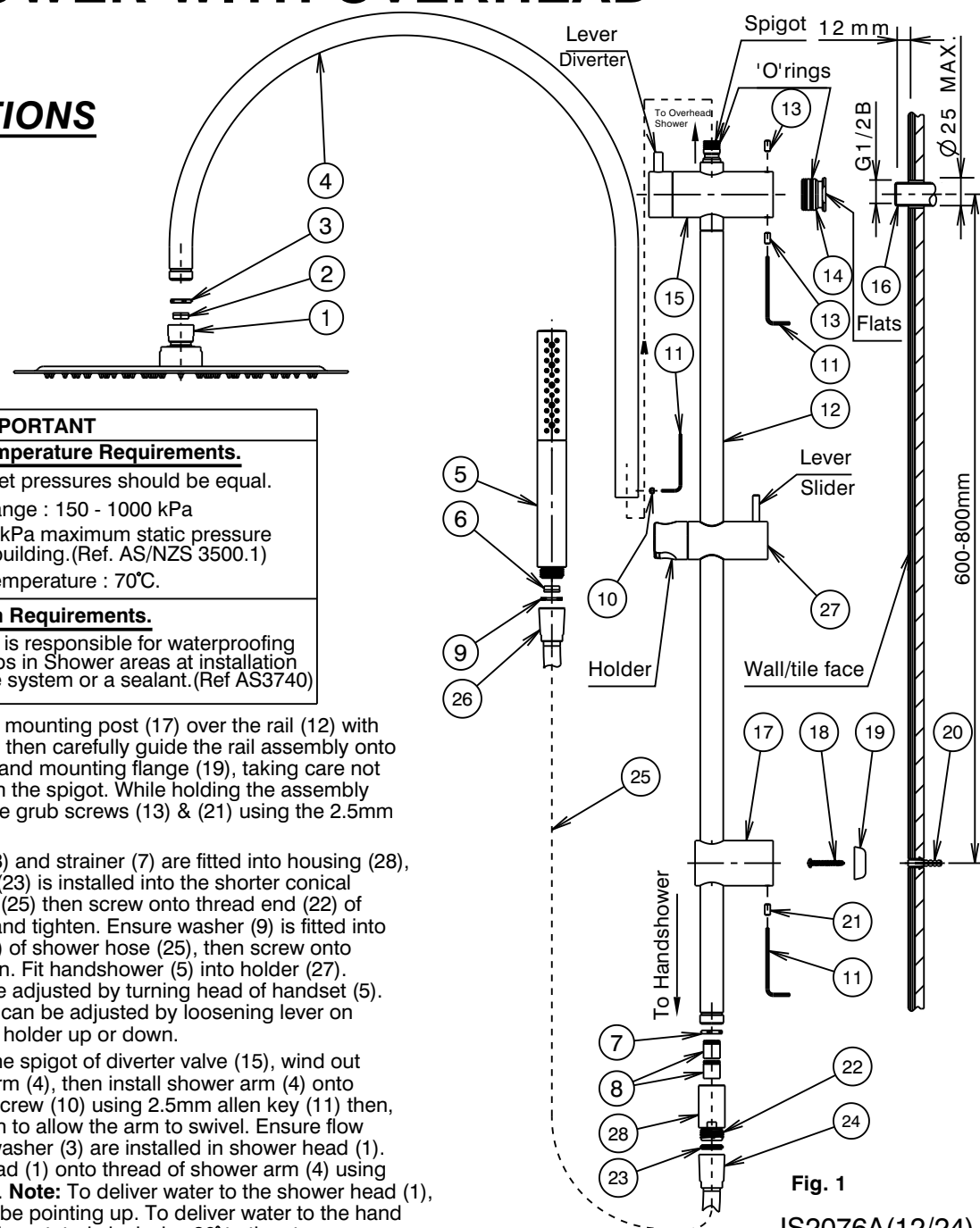

Fig. 1

IS2076A(12/24)