

Caroma® 'G' SERIES PLUS- HOB SINK EXPOSED SET

WATER EFFICIENT TAPWARE

PLUMBERS INSTALLATION INSTRUCTIONS

Important Information

- * Not suitable for gravity feed systems.
- * It is recommended that the outlet (17) be fitted prior to installing the breech (14) into the deck. (see Fig.5, Sht 2).
- * The outlet is fitted with a flow regulated aerator insert. This low flow rate may not be suitable for connection to some Instantaneous Gas Water Heaters, some Tempering Valves, some Solar Water Heaters & some Thermostatic Mixing Valves. Check with the manufacturers of these products.
- * Isolating stop taps are recommended to be fitted to the inlet connections. (Part No: 842018C - Mini cistern 1/4 T)
- * All pipework must be thoroughly flushed prior to installation, as foreign materials may block the flow regulating device and reduce the flow of water. Note: Aerator insert housing must be retightened to prevent removal by hand.

Installation (Fig.1 & 2 or 3)

- 1) Fit 'O' rings (11) into grooves in underside of breech bodies (10). Fit breech assembly (14) into holes in deck, taking care that 'O' rings (11) remain in position. Fit one washer (12) and one backnut (13) to each tail and tighten.
- 2) Determine handle closing position.
 - Forward closing lever handles** (ideal for opening using elbows) (Fig.2). Proceed to step 4.
 - Outward closing lever handles** (more suitable for opening by hand) (Fig.3). Proceed to step 3.
- 3) Remove locknuts (7) and fibre washers from cartridges (8). Unscrew cartridges (8) from breech bodies (10). Screw cartridge (8) (with red seal 9) into left hand 'hot side' breech body (10). Using a suitable spanner, tighten cartridge (8) until it comes to a firm stop (DO NOT TIGHTEN CARTRIDGE USING SPINDLE). Fit fibre washer and then locknut (7) and tighten using a suitable spanner, taking care not to damage the thread. Fit cartridge (8) (with blue seal 9) into right hand 'cold side' breech body (10) in a similar manner.
- 4) With cartridge spindles in the fully closed position (Fig.2 or 3), fit inserts (6) onto spindles then check that lever of handles (1) are in correct alignment with each other when fitted to handle inserts (6). For small adjustments to handle position, cartridge (8) can be rotated **slightly** in an anti-clockwise direction until handles are aligned before tightening locknut (7). Remove handles (1) then fit washers (5) & nuts (4) to thread of spindles and tighten to secure inserts (6). Align handles (1) as before then engage with insert (6) & tighten screw (2) with 2mm allen key (3).

IMPORTANT	
Pressure & Temperature Requirements.	
• Hot and cold water inlet pressures should be equal.	
• Static inlet pressure range : 150 -1000 kPa	
New Regulation :-500 kPa maximum static pressure at any outlet within a building.(Ref. AS/NZS 3500.1)	
• Maximum hot water temperature : 80°C.	
Deck Requirements	
• Centre distance between tap body holes : 150±1mm	
• Deck thickness : 40mm maximum	
• Tap body holes (in deck) : Ø22-26mm	

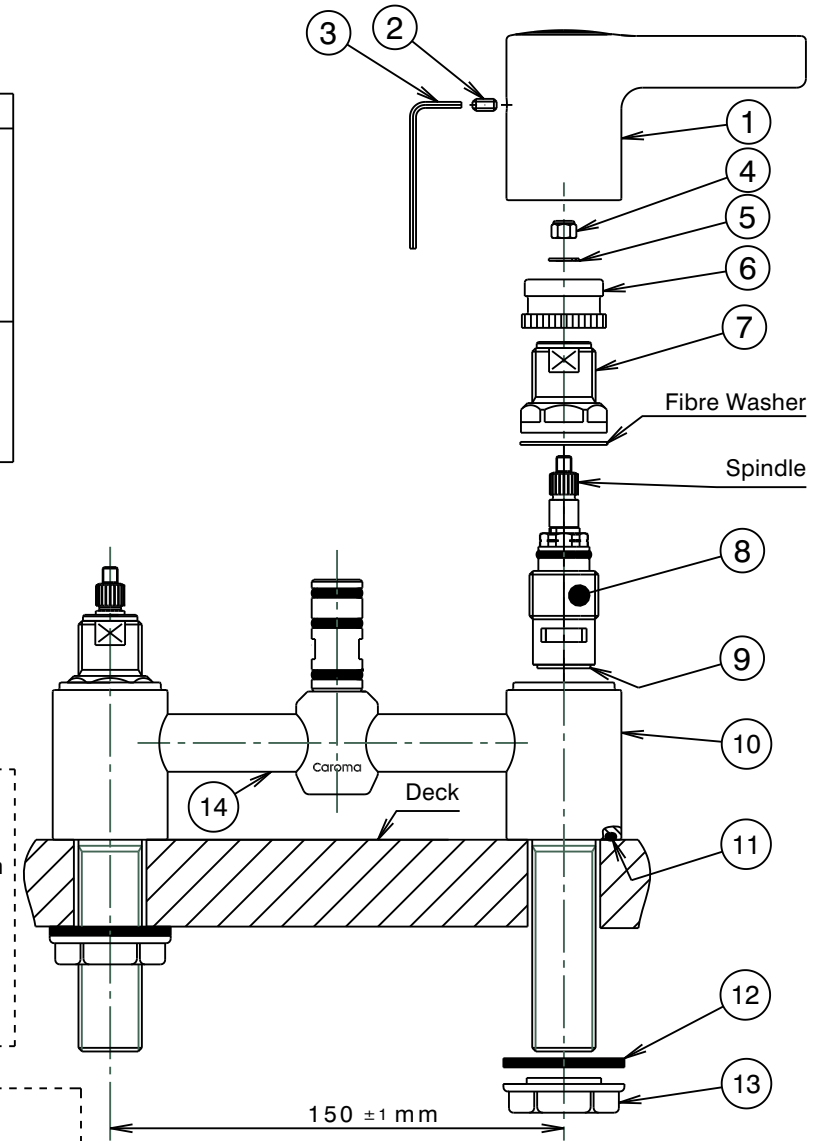

Fig.1 Front View

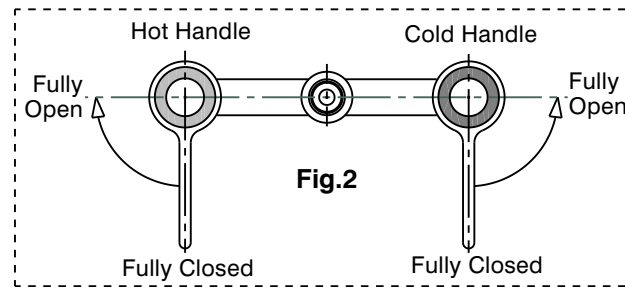

Fig.2

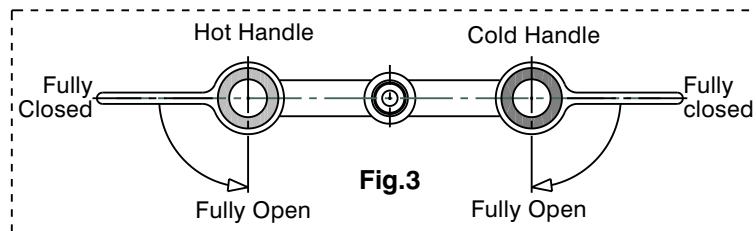

Fig.3

Caroma® 'G' SERIES PLUS- HOB SINK EXPOSED SET

WATER EFFICIENT TAPWARE

PLUMBERS INSTALLATION INSTRUCTIONS

Installing the outlet (Fig.5)

Determine if the outlet (17) is to be fixed or swivel.

- 1) For a fixed outlet select the retainer (16a) or if 100°restricted swivel is required select the smaller retainer (16b). Fit the retainer (16a or 16b) into the spigot groove, as shown.
 - 2) Ensure suitable lubricant is applied to the retainer & 'O' rings, then carefully slide the outlet (17) onto the spigot of breech (14). Rotate the outlet (17) to align the hole in the outlet with the threaded hole in the retainer (16a or 16b) then fit screw (15a or 15b) and tighten using the 2mm allen key (3).
- Important:** The correct retainer/screw combination must be used (16a/15a) or (16b/15b), as shown.

Changing the indicator (Fig.4)

- 1) Loosen screw (2) using a 2mm allen key (3) & remove handle (1). Remove screw (21) & washer (22) using a 3mm allen key. Push out retainer (24) & indicator (23).
- 2) Push in new indicator (23) followed by retainer (24). Assemble screw (21) with washer (22) then screw into the retainer (24) & tighten with the 3mm allen key. Align handle (1) as before then engage with insert (6) & tighten screw (2) with 2mm allen key (3).

Cleaning the Aerator Insert (Fig.5)

- 1) Carefully remove housing (18) from outlet tube (17), taking care not to damage the decorative finish.
- 2) Remove 'O'ring (20) & aerator insert (19) from housing (18). Check that housing is clean. Deposits of lime can be removed by washing in a vinegar solution.
- 3) Fit aerator insert (19) into housing (18) followed by 'O'ring (20) then screw assembly onto outlet tube (17) & tighten securely (to prevent removal by hand).

