

FREE STANDING BATH SPOUT

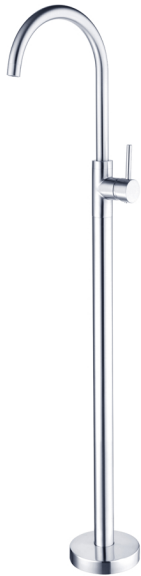

SPECIFICATION

PRODUCT CODE	YSW2109-03A-01
WELS RATING	N/A
WATERMARK LICENSE	WM-060073
TEMPERATURE RATING	MIN 1°C-MAX 75°C
PRESSURE RATING	MIN 150KPa-MAX 500KPa

FINISH

NR210903a01CH	chrome
NR210903a01BZ	brushed bronze
NR210903a01MB	matte black
NR210903a01BN	brushed nickel
NR210903a01GM	gun metal
NR210903a01BG	brushed gold
NR210903a01GR	graphite

MAINTENANCE AND CARE

All surfaces should be cleaned with mild liquid detergent or soap and water.

Do not use cream cleaners or citrus based cleaning products, as they are abrasive.

Use of unsuitable cleaning agents may damage the surface. Any damage caused in this way will not be covered by warranty.

PACKAGING INCLUDES

- 1x mixer body
- 1x straight tube
- 1x escutcheon
- 1x triangle bracket
- 3x expansion screw
- 1x gloves
- 1x manual
- 1x allen key

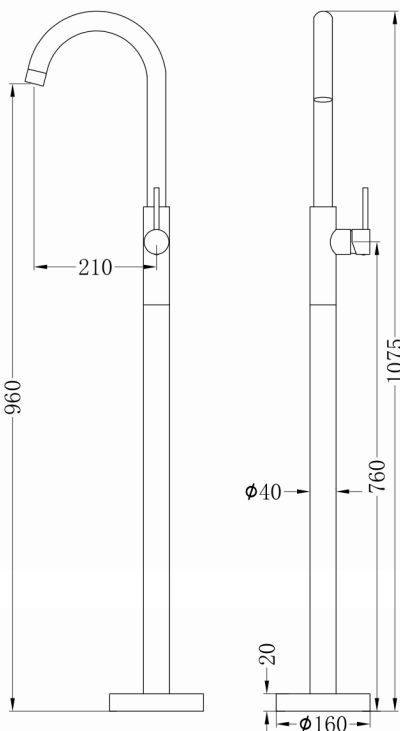

Dimensions are nominal measurements only.



Installation Instruction

Please inspection all spare parts list when you open box, if any problem, please contract with seller. Spare parts list as follow.

Item	Parts Name	QTY
1	Mixer Tap	1
2	Extension Tube	1
3	Floor Cover Plate	1
4	Water Pipes	2
5	Mixer Box	1
6	Dynabolt	4
7	Gloves	1
8	Instruction	1
9	Allen Key Pack	1
10	Leveling Plate	1
11	Gradiometer	1
12	Testing Plugs	1

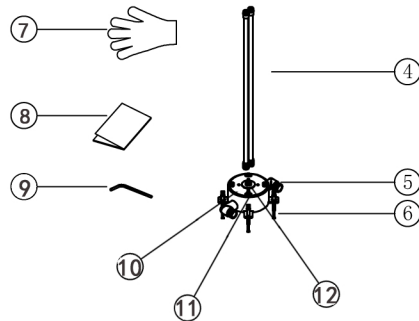
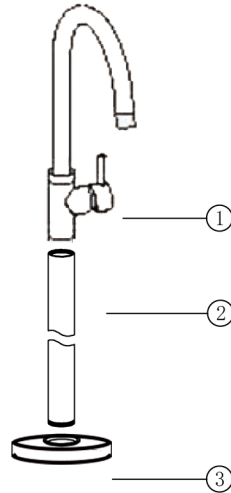

Notice: Not recommend to be installed on concrete slab

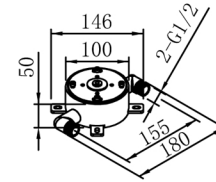

1. Mixer box should not finish more than 2mm above finish tile level

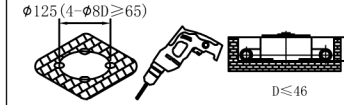

2. Connect hot and cold water use materials recommended Australian standard

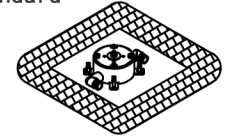

3. Adjust mixer box make sure in a level by gradiometer provided

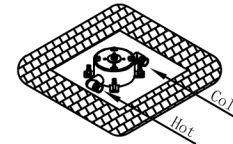

4. Test and check for water leaks

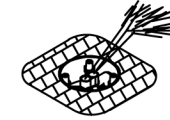

5. Undo 4 grub screws on the leveling plate and take out the gradiometer and testing plug.

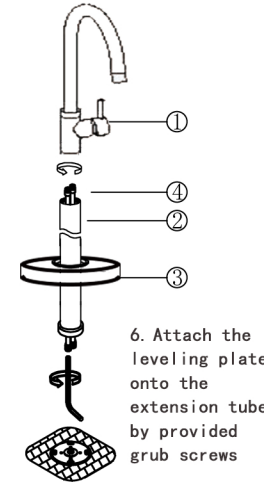
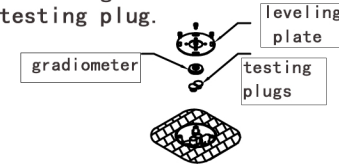

6. Attach the leveling plate onto the extension tube by provided grub screws

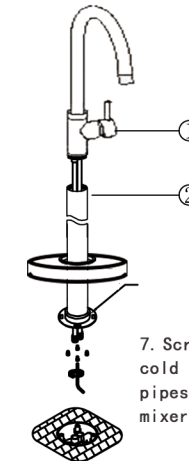

7. Screw hot and cold water pipes into the mixer body

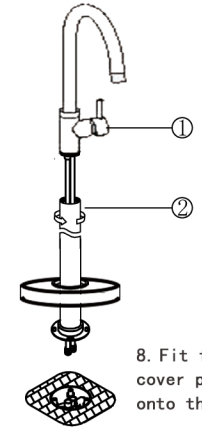

8. Fit floor cover plate onto the

10. Flush pipes work and test, check for water leaks.

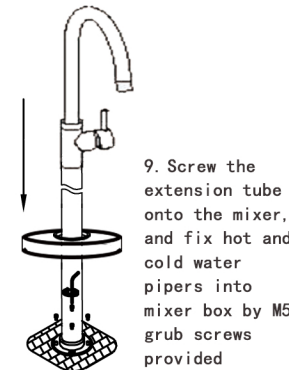

9. Screw the extension tube onto the mixer, and fix hot and cold water pipers into mixer box by M5 grub screws provided

