

PLUMBERS INSTALLATION INSTRUCTIONS

For Vitreous China Liano Junior Cleanflush® Wall Faced Close Coupled Suite

PLEASE READ CAREFULLY BEFORE INSTALLATION

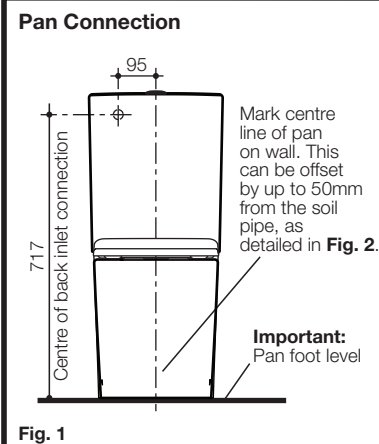

Fig. 1

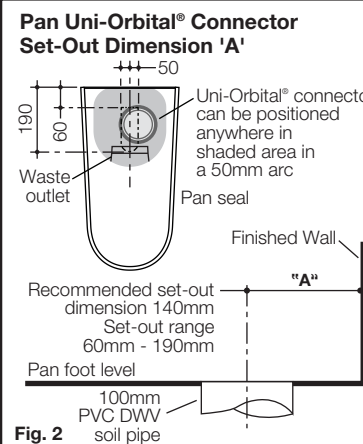

Fig. 2

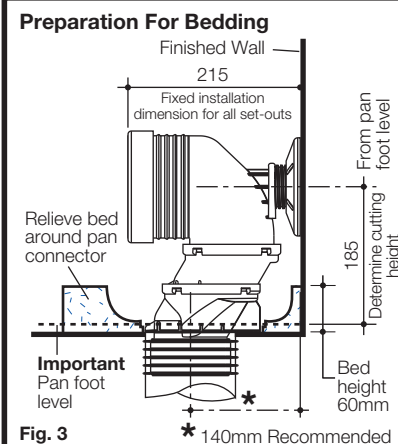

Fig. 3

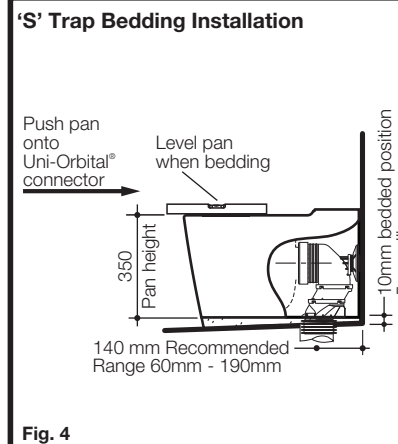

Fig. 4

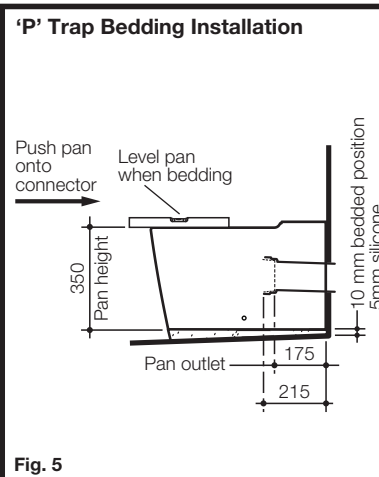

Fig. 5

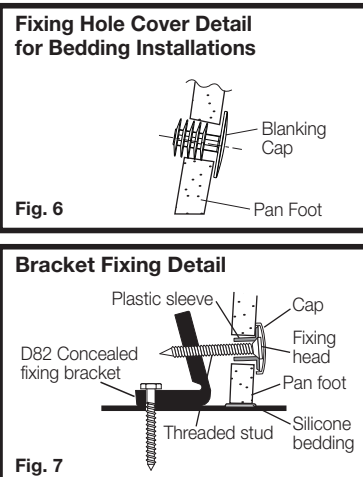

Fig. 6

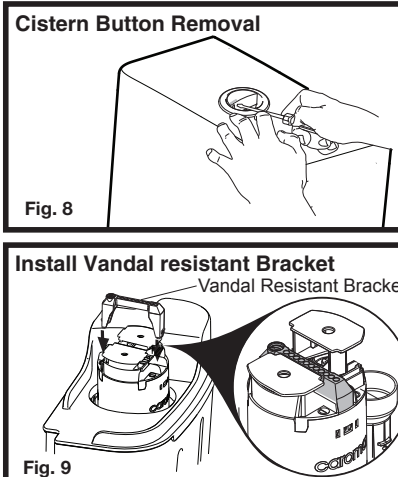

Fig. 8

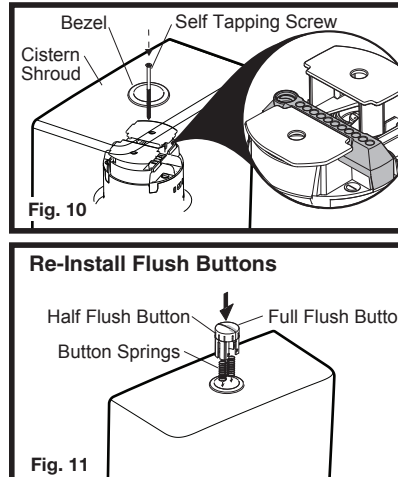

Fig. 10

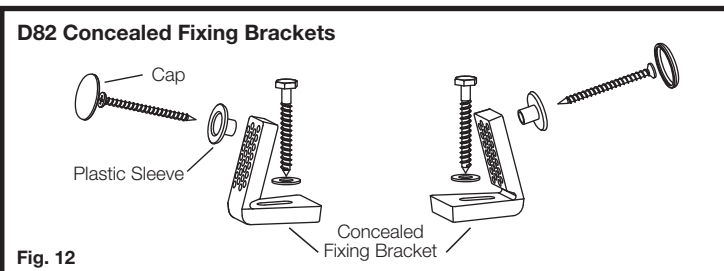

Fig. 12

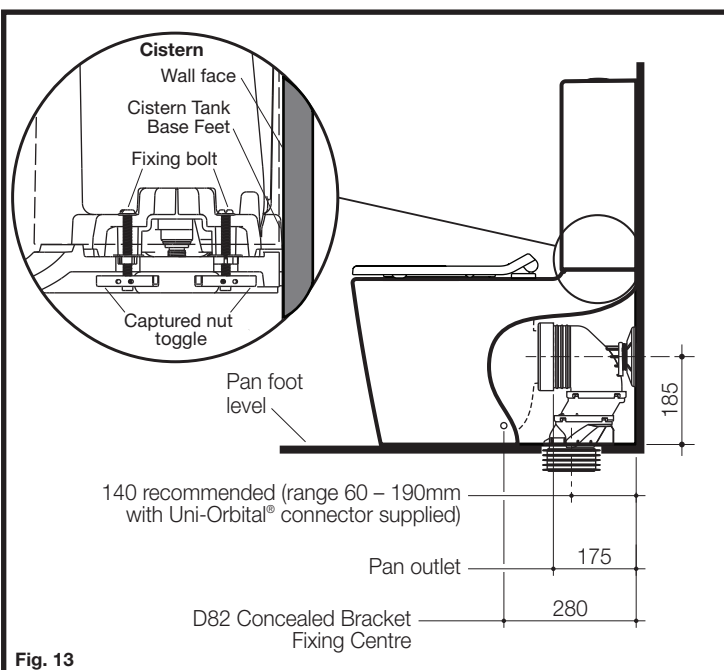

Fig. 13

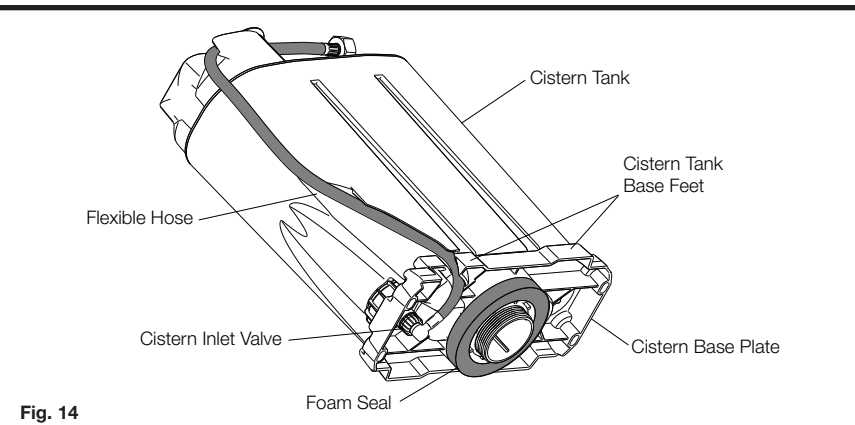

Fig. 14

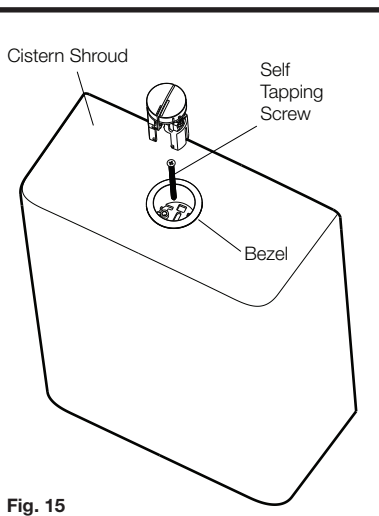

Fig. 15

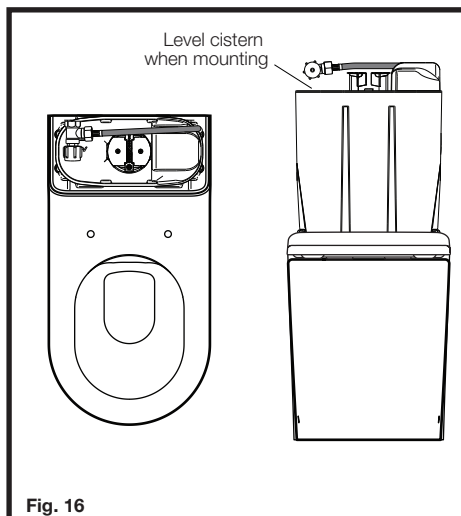

Fig. 16

ROUGHING IN:

The Liano Junior Cleanflush® pan is universal for both 'S' and 'P'-Trap installations as detailed. The recommended set-out for 'S'-Trap installations is 140mm from the finished wall with set-out flexibility for existing soil pipe positions ranging from 60mm to 190mm and 50mm sideways adjustment with the Uni-Orbital® connector supplied, as detailed in Fig. 2.

'S'- TRAP CONNECTOR FIXING PROCEDURE

- 1- Mark centre line of the pan on finished wall, as detailed in Fig. 1. This is to be used as a guide when connecting the pan. The centre line can be offset by up to 50mm from the soil pipe, as detailed in Fig. 2.
- 2- Determine set-out "A" of soil pipe, as detailed in Fig. 2. Set-out range 60mm - 190mm. Recommended set-out 140mm, as detailed in Fig. 3. For 'P' trap installation see Fig. 5.
- 3- For installation of the Uni-Orbital® connector, reference must be made to the instructions supplied with the connector.
- 4- Prepare for pan fixing method (either bedding or bracket installation) as detailed below.

PAN/CLOSET FIXING PROCEDURE

Pan bedding:

- 1- Remove an area of tiles which are within the internal area covered by the foot of the pan to expose the sub floor and provide a bondage key for the bedding mixture.
- 2- Ensure that the bedding area is clean and free of building material.
- 3- Locate blanking cap (supplied) into pan fixing holes as detailed in Fig. 6.
- 4- Prepare bedding sand cement mixture 3:1 to depth of 60mm as detailed in Fig. 3. **Note:** Do not fill the foot of the pan with bedding mix or include lime or fast drying cement into the mix, these may cause cracking in the foot of the pan.
- 5- Position and push pan into connector using the marked centre line on the wall as a guide and level pan into bedding mixture, so that the back of the foot of the pan is approximately 10mm above the finished floor as detailed in Fig. 4. It is recommended that wedges are used to support the foot of the pan during the positioning.
- 6- Locate the cistern shroud on to the pan and check that the cistern shroud is level (side to side) and aligned with the tiling edges. Adjust pan position if necessary. Allow bedding mixture to set for at least 24 hours prior to use.

Bracket fixing:

- 1- Position and push pan into connector using the marked centre line on the wall as a guide and locate the cistern shroud onto the pan, checking that the cistern aligns with the finished wall. Adjust pan position if necessary. Remove the cistern and pan.
- 2- Locate the D82 Concealed Fixing brackets into position on centre line of pan 280mm from the finished wall and mark bracket fixing hole centres on finished floor.
- 3- Drill two holes in the marked positions on the floor. The hole diameter is dependent on the type of fixing system and floor finish.
- 4- Secure Brackets to finished floor.
- 5- Ensure that the area around the floor is clean and free from building material.
- 6- Run a bead of acetic cured silicone sealant at a height of 8mm approximately fully around the foot of the pan which contacts the floor. Use Wedges around the foot base (if required) so that the **maximum height of silicone sealant is not greater than 5mm on completion on bedding.**

- 7- Connect pan to connector and locate plastic fixing sleeve into holes in the pan. Fit screw into the bracket and tighten to bed pan to floor while ensuring level, as detailed in Fig. 7. **IMPORTANT - DO NOT OVERTIGHTEN, AS THIS MAY CRACK THE PAN FOOT.** Snap on plastic cap, as detailed in Fig. 7.

- 8- Provide support under the pan foot so that it is maintained in the levelled position while the silicone sealant sets. Remove any excess sealant to provide a neat joint between the pan and the floor. Allow at least 24 hours for the bedding sealant to set before use.

CISTERN FIXING PROCEDURE

Shrouded cistern with back inlet wall connection (Internal overflow only) installation.

Note: The cistern fixes directly to the pan with a robust base fixing system without the need for wall fixing.

- 1- Fit Foam Seal to underside of cistern tank, as detailed in Fig. 14.
- 2- Lubricate the 90° elbow connection of the Flexible Hose before connecting Flexible Hose to Cistern Inlet Valve, making sure the 'O'-ring on the elbow spigot has fully entered the inlet valve. Fit the Flexible Hose through the Cistern Base Plate and up the side of the Cistern then across the top of the Cistern using the hose path slots incorporated into the cistern design, as shown in Fig. 14.
- 3- Ensure that the stop cock is attached to the back inlet connection on the left hand side as shown in Fig. 1 and the Cistern Inlet Valve is on the right hand side, as shown in Fig. 14.
- 4- Position the Cistern Tank Base Feet against the wall face as shown in Fig. 13 and check that Fixing Bolts slots are aligned with the Captured Toggle Nuts.
- 5- Insert the 4 Fixing Bolts into the slots and secure cistern to pan with Fixing Bolts as detailed in Fig. 13. Tighten the 4 screws while holding the Cistern Base Plate against the wall. Ensure cistern is level and centered on the pan. Do not overtighten.
- 6- Flush the line before connecting water supply and check cistern operation. **IMPORTANT:** Check for leaks and that the Flexible Hose does not interfere with the flush buttons.
- 7- Clip the Vandal Resistant Bracket into the top of the outlet valve as shown in Fig. 9. Make sure the large threaded hole is towards the back of the cistern.
- 8- Remove 1/2 flush and full flush buttons from bezel as shown in Fig. 8 by depressing one button. Prise out one button, then remove the second button.
- 9- Carefully slide the Vitreous China Cistern Shroud over the Cistern Tank. Make sure the back of the Cistern Shroud is aligned with the wall face. The back of the shroud should slide between the Cistern Base Plate and the wall face.
- 10- Insert Self Tapping Screw (supplied with Cistern Shroud) into centre slot of bezel and tighten screw until it secures Cistern Shroud onto Cistern, as detailed in Fig. 10. Do not overtighten. Replace springs and buttons back into place and check smooth operation of both buttons.
- 11- To access cistern for service, remove buttons as detailed in Fig. 8. Undo Self Tapping Screw shown in Fig. 10 and carefully lift off cistern shroud.



IMPORTANT
TO ACHIEVE A SATISFACTORY 4.5/3L FLUSH PERFORMANCE AND A 4 STAR WATER EFFICIENCY RATING THE CISTERN MUST BE MATCHED WITH A COMPATIBLE CAROMA SMARTFLUSH 4.5/3L TOILET PAN.

All measurements are subject to accepted manufacturing tolerances. To ensure accuracy please check actual product dimensions before drilling for installation. The manufacturer reserves the right to change specifications at any time without giving prior notification. This product should be installed by a qualified plumber. Local authority, Water Board, and Building Regulations may apply to the installation of this product, and you should consult the appropriate bodies on these requirements.