

CABINET SPECIFICATIONS



UNICAB™ Wall-Hung Cabinet

- High quality, UV resistant gloss white exterior
- Bright white interior
- Soft-close doors & drawers
- Full extension drawer runners
- 16mm thick backing boards & drawer bases
- FSC certified, eco-friendly E0 board
- Includes aluminium chrome finish handles as standard
- 490mm tall (without top)

600 width
\$349
60J

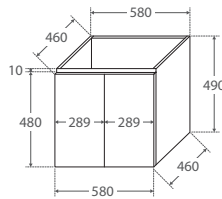

TOP VIEW: SHELF AREA

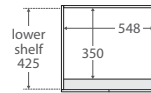

SIDE VIEW: SHELF STORAGE

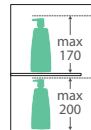

750 width
\$425

LEFT drawers: 75JL
RIGHT drawers: 75JR

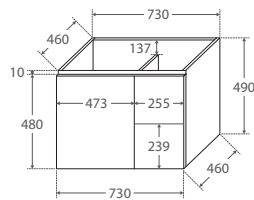

TOP VIEW: SHELF AREA & DRAWER AREA

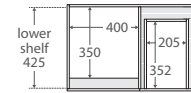

SIDE VIEW: SHELF STORAGE

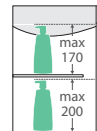

SIDE VIEW: RECESS & DRAWER STORAGE

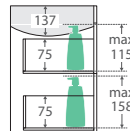

1200 width
\$650

120J

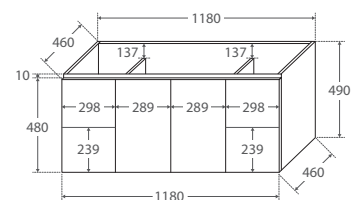

TOP VIEW: SHELF AREA & DRAWER AREA

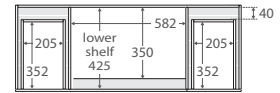

SIDE VIEW: SHELF STORAGE

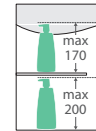

SIDE VIEW: RECESS & DRAWER STORAGE

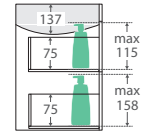

900 width
\$480

LEFT drawers: 90JL
RIGHT drawers: 90JR

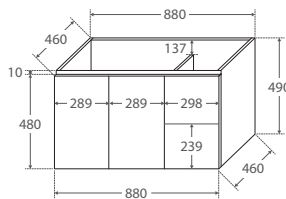

TOP VIEW: SHELF AREA & DRAWER AREA

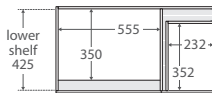

SIDE VIEW: SHELF STORAGE

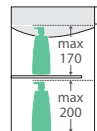

SIDE VIEW: RECESS & DRAWER STORAGE

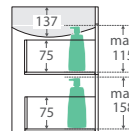

1500 width
\$850

150J

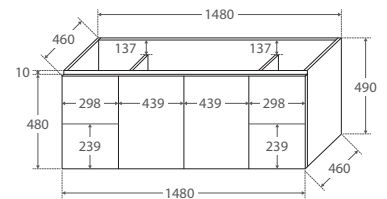

TOP VIEW: SHELF AREA & DRAWER AREA

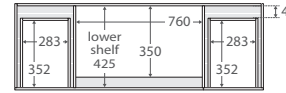

SIDE VIEW: SHELF STORAGE

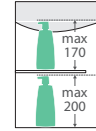

SIDE VIEW: RECESS & DRAWER STORAGE

