



## UNICAB™ Cabinet on Legs

- High quality, UV resistant gloss white exterior
- Bright white interior
- Soft-close doors
- Full extension drawer runners
- 16mm thick backing boards & drawer bases
- FSC certified, eco-friendly E0 board
- Includes round aluminium chrome finish legs and handles as standard
- Extra high – 880mm tall (without top)

Upgrade legs and handles on page 5 in Moulded Basin-Tops



### 600 width \$349

60NLW

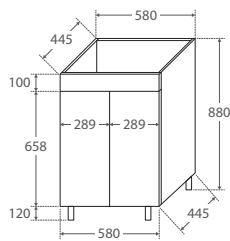

TOP VIEW: SHELF AREA

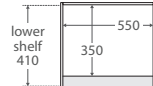

SIDE VIEW: SHELF STORAGE

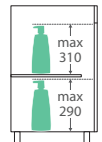

### 900 width \$480

LEFT drawers: 90NLWL  
RIGHT drawers: 90NLWR

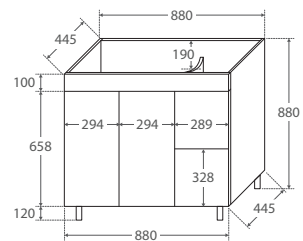

TOP VIEW: SHELF AREA & DRAWER AREA

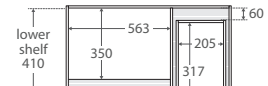

SIDE VIEW: SHELF STORAGE

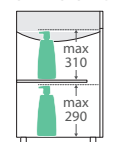

SIDE VIEW: RECESS & DRAWER STORAGE

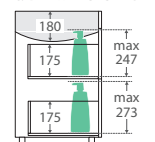

### 750 width \$425

LEFT drawers: 75NLWL  
RIGHT drawers: 75NLWR

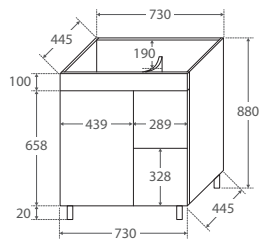

TOP VIEW: SHELF AREA & DRAWER AREA

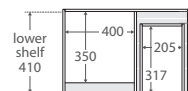

SIDE VIEW: SHELF STORAGE

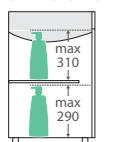

SIDE VIEW: RECESS & DRAWER STORAGE

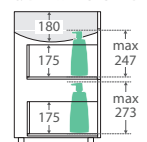

### 1200 width \$650

120NLW

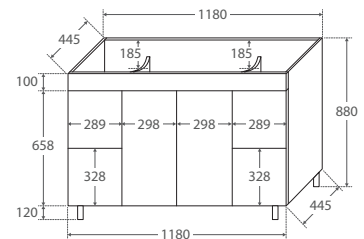

TOP VIEW: SHELF AREA & DRAWER AREA

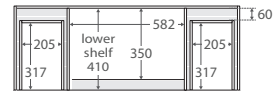

SIDE VIEW: SHELF STORAGE

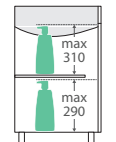

SIDE VIEW: RECESS & DRAWER STORAGE

