

CABINET SPECIFICATIONS



EDGE Industrial Wall-Hung Cabinet

- Industrial textured print on interior & exterior
- Bevelled edge pull-channel
- Soft-close doors & drawers
- Full extension drawer runners
- 16mm thick backing boards & drawer bases
- 650mm tall (without top)

600 width
\$349

60X

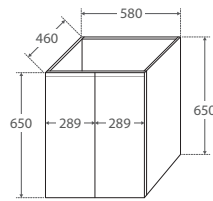

TOP VIEW: SHELF AREA

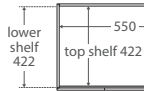

SIDE VIEW: SHELF STORAGE

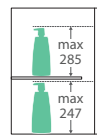

**Bevelled
edge pull-
channel**



750 width
\$425

LEFT drawers: 75XL
RIGHT drawers: 75XR

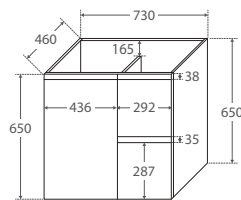

TOP VIEW: SHELF AREA & DRAWER AREA

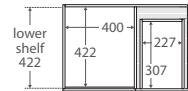

SIDE VIEW: SHELF STORAGE

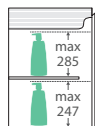

SIDE VIEW: RECESS & DRAWER STORAGE

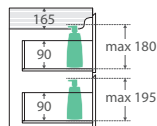

1200 width
\$650

120X

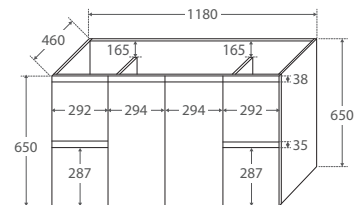

TOP VIEW: SHELF AREA & DRAWER AREA

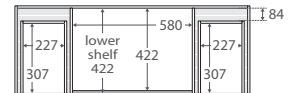

SIDE VIEW: SHELF STORAGE

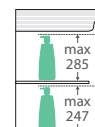

SIDE VIEW: RECESS & DRAWER STORAGE

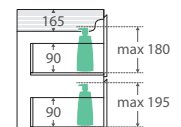

900 width
\$480

LEFT drawers: 90XL
RIGHT drawers: 90XR

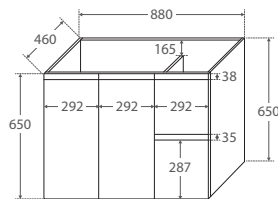

TOP VIEW: SHELF AREA & DRAWER AREA

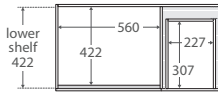

SIDE VIEW: SHELF STORAGE

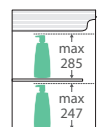

SIDE VIEW: RECESS & DRAWER STORAGE

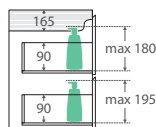

1500 width
\$850

150X

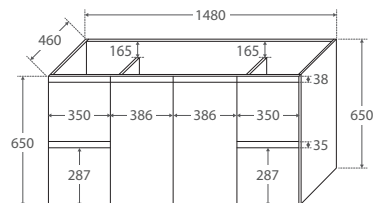

TOP VIEW: SHELF AREA & DRAWER AREA

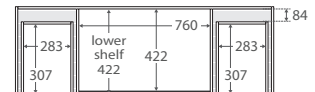

SIDE VIEW: SHELF STORAGE

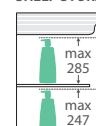

SIDE VIEW: RECESS & DRAWER STORAGE

