

INSTALLATION INSTRUCTIONS

ASSIST+ SPECIAL NEEDS

TOILET SEAT

JohnsonSuisse
Bathroom Solutions

PRODUCT CODE Assist+ Special Needs Toilet Seat - Blue RB6044B
Assist+ Special Needs Toilet Seat - Grey RB6044G
Assist+ Special Needs Toilet Seat - White RB6044W



The Assist+ Toilet Seat is supplied in Blue or Grey for AS1428.1 installation compliance.

The seat is also available in White for assisted living/geriatric applications

Lateral stabilisers are incorporated in the design of the seat

INSTALLATION STEPS

1. Insert the top-fix fittings into the seat bolt holes of the WC pan. Push down firmly.
2. Attach the hinge bases and lightly screw down the fixing bolts
3. Fit the hinge mechanisms to the seat - ensure that the holes for the fixing screws face to the front of the pan.
4. Slide the seat and hinge assembly back and check the fit of the seat to the pan. adjust as necessary. Remove seat and tighten fixing bolts firmly. Refit the seat.
5. Insert and tighten the fixing screws
6. Fit the lateral stabilisers so that they are located correctly just on the inside of the bowl rim. Fit the stabiliser cover pads.

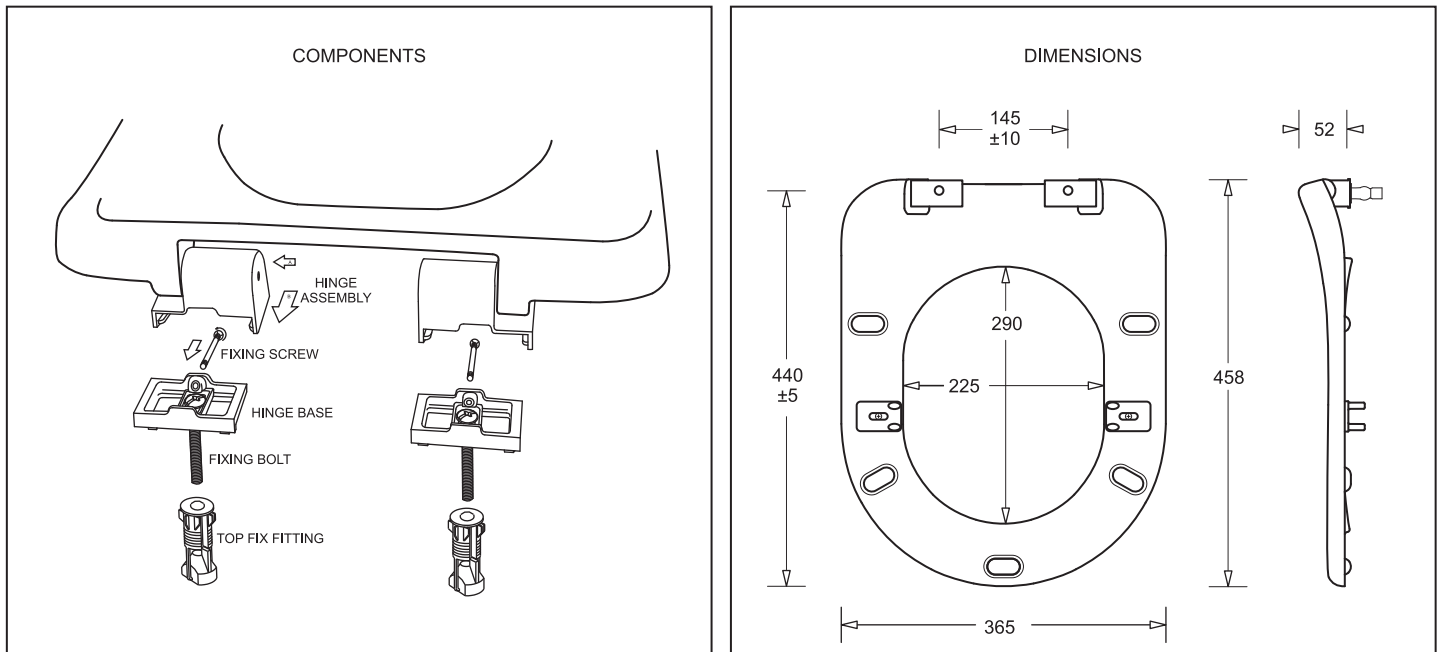

CARE

1. Clean only with a soft cloth using mild soapy warm water
2. Do not use solvent based chemicals
3. Do not use harsh or abrasive cleaners

All installations should be carried out by a licensed plumber in compliance with the Plumbing Code of Australia and any State or Local Authority Regulations