

INSTALLATION INSTRUCTIONS

WINDSOR CISTERN SEAT AND LINK



PRODUCT CODE: G1200A

INSTALLATION STEPS

1 Check that the cistern can be installed within the tolerances shown. Mark the position of the fixing screw holes - use the keyholes or the clips for the Cistern mounting. Ensure that the holes are level.

2 Drill 8mm diameter holes and insert the plastic wall plugs provided and leave the screws protruding by approximately 15mm.

3 Cut the flush pipe to suit the installation and fit the appropriate rubber connector

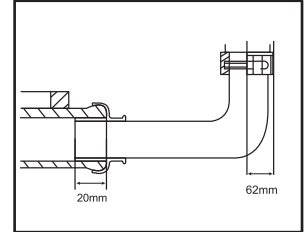
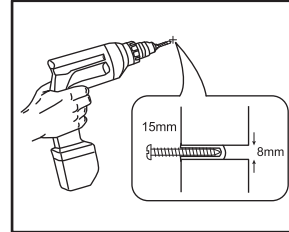
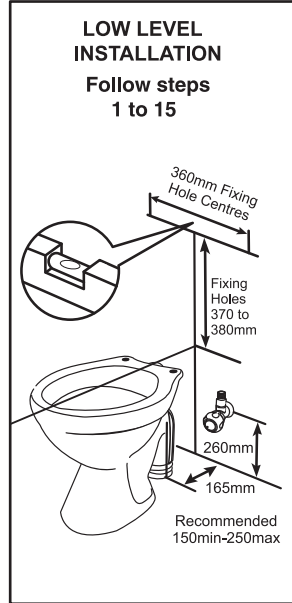
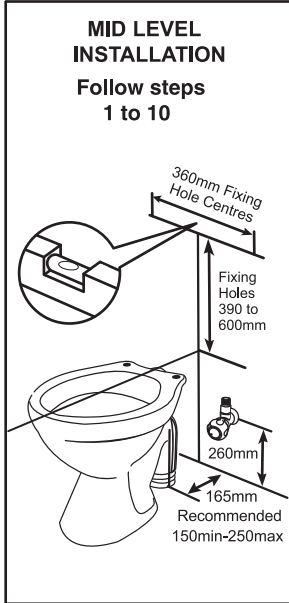

4 Fit the capnut

5 Tighten the protruding screws to the cistern.

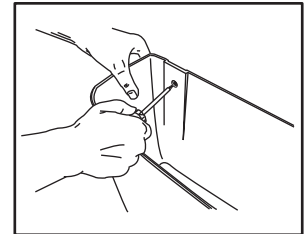
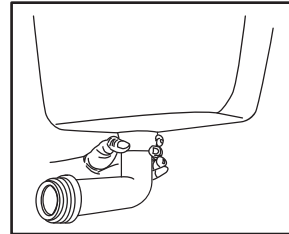

6 Flush water before connection to inlet valve.

7 Fit the water supply pipe to inlet valve using an approved fitting.

8 Turn on the water and check for leaks (as per drawing).

9 Check the level if necessary adjust inlet valve.

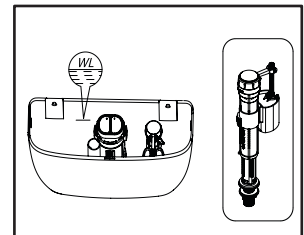
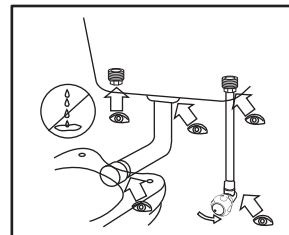
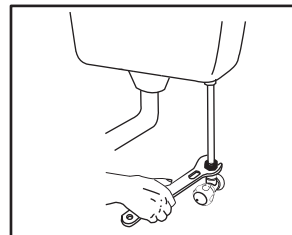
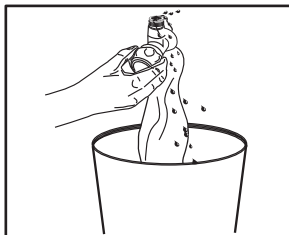

10 Ensure spreader is in place and fit the lid.

11 Continue from step 3 - Fit in the link piece to cap nut.

12 Clip the link piece in position and mark as shown by positioning the seat flap.

13 Cut off the excess. There are cutting guide lines on the underside.

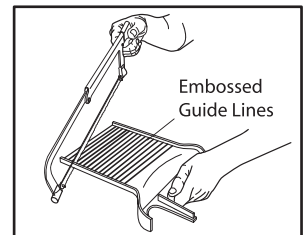
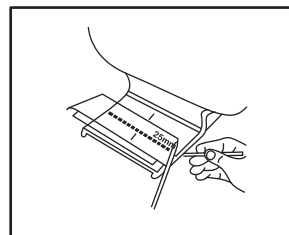
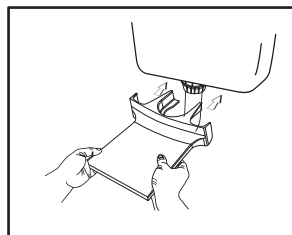
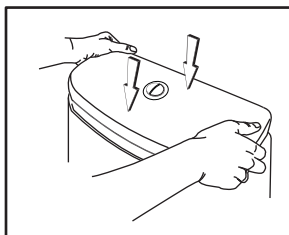

14 Fix the bolts to the seat and fit the link piece into the seat flap.

15 Tighten the seat nuts. Ensure the rubber washers are correctly fitted

16 Seat assembly arrangement

It is recommended that the cistern is test flushed several times to check the performance

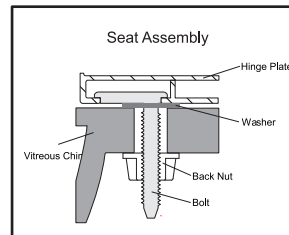
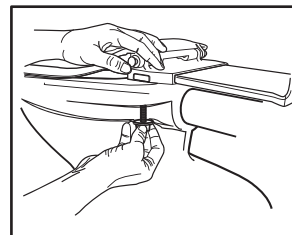
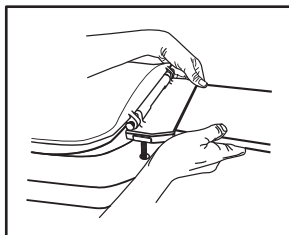

⚠ WARNING

DO NOT USE CHLORINE/CHEMICAL SANITISERS IN THE CISTERN TANK. THE CHEMICALS IN SANITISERS MAY RESULT IN COMPONENT DAMAGE AND WILL VOID THE PRODUCT WARRANTY.

INSTALLATION INSTRUCTIONS

WINDSOR CISTERN SEAT AND LINK



PRODUCT CODE: G1200A

INSTRUCTIONS FOR ADJUSTING THE CISTERN FLUSH VOLUME

This cistern is supplied pre-set to flush 4.5/3 litres. When the cistern is to be retro fitted to an existing WC, it may be necessary to adjust the flush volume to 6/3 or 9/4.5 litres.

1. Before starting, ensure that the water supply to the cistern is turned off
2. Push the full flush button to empty the cistern
3. Remove the cistern lid
4. **OUTLET VALVE ADJUSTMENT** (Diagrams A,B,C below)
 - a) Remove the outlet valve - hold the body and twist to remove
 - b) Adjust the Full Flush setting up or down to the correct position for the required volume
 - c) Slide the Reduced Flush Setting by sliding up or down to the correct position
 - d) Unlock (twist) and slide the inner overflow tube to the correct position. Twist to lock
 - e) Refit the valve - make sure that the blue button on the valve top matches with the half flush button
5. **INLET VALVE ADJUSTMENT** (Diagrams D,E below)
 - a) To simplify adjustment the inlet valve can be removed from the cistern
 - e) Remove the body locking clip and twist the valve body clockwise to release. Slide to adjust the body to the correct measurement and twist to relatch. Replace the body locking clip.
 - b) Unlock the float cup and slide to adjust to the correct position (the bottom of the float cup adjusting ring should be just above the setting mark)
 - c) Relock the float cup
 - d) Adjust the float screw until the top surface of the float is level with the float cup rim
 - e) Refit the valve
6. Replace cistern lid and check the water levels and the flush action

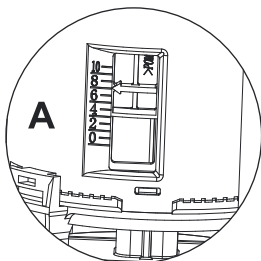

		Flush Volume		
Outlet Valve		4.5/3L Factory Set	6/3L	9/4.5L
A	Full Flush Setting	10	1	0
B	Reduced Flush Setting	1.5	2	5
C	Overflow Height setting	Fully Closed	Fully Closed	2

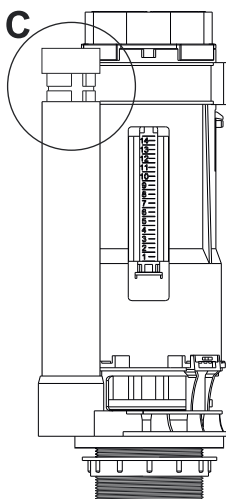
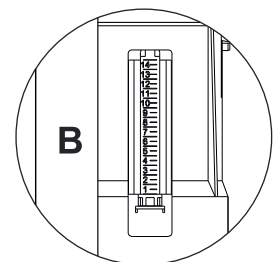

		Inlet Valve		
D	Height (D)	108 mm	108 mm	143 mm
E	Float Cup Setting	0	0	2

