

Nero

BIANCA FLOORMOUNT BATH MIXER

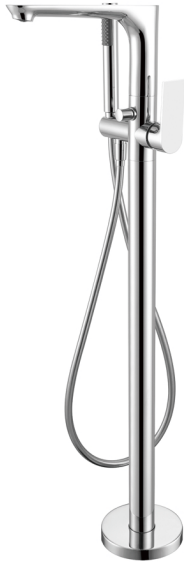

SPECIFICATION

PRODUCT CODE	YSW3215-03A
WELS RATING	3 STAR 9L/MIN
WATERMARK LICENSE	WM-060073
TEMPERATURE RATING	MIN 1°C-MAX 75°C
PRESSURE RATING	MIN 150KPa-MAX 500KPa

FINISH

NR321503aCH	chrome
NR321503aMB	matte black
NR321503aBN	brushed nickel
NR321503aGM	gun metal
NR321503aBG	brushed gold

MAINTENANCE AND CARE

All surfaces should be cleaned with mild liquid detergent or soap and water.

Do not use cream cleaners or citrus based cleaning products, as they are abrasive.

Use of unsuitable cleaning agents may damage the surface. Any damage caused in this way will not be covered by warranty

PACKAGING INCLUDES

- 1x mixer body
- 1x handshower
- 1x shower hose
- 1x straight tube
- 1x escutcheon
- 2x flexible hose
- 1x triangle bracket
- 3x expansion screw
- 1x gloves
- 1x manual
- 1x allen key

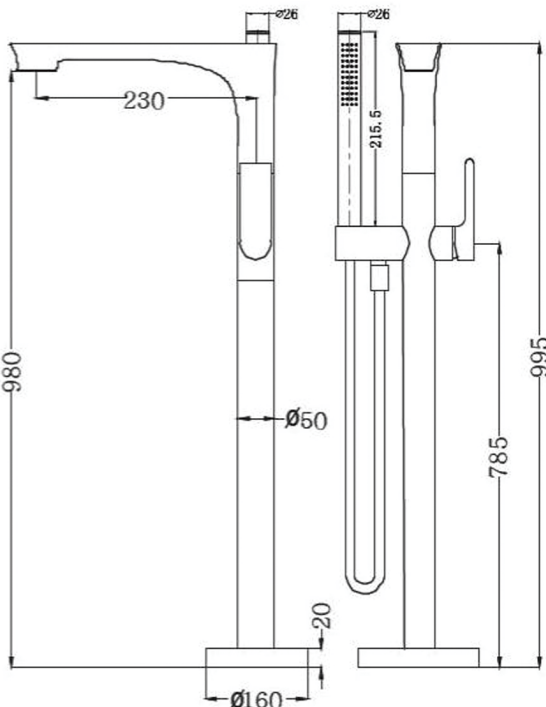

Dimensions are nominal measurements only.



Versions: 2019.11

www.nerotapware.com.au

Floor bathtub mixer instruction

Please inspection all spare parts list when you open box, if any problem, please contract with seller. Spare parts list as follow.

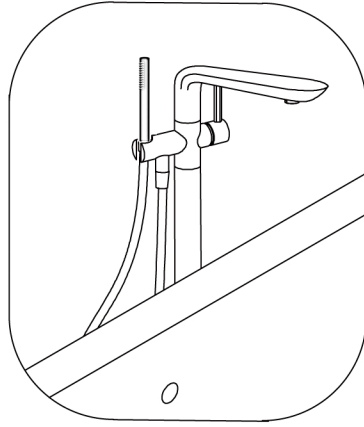

NO	Product Description	QTY
1	Control body	1
2	Body Pipe	1
3	Cover plate	1
4	Water pipe	2
5	N-box	1
6	Expansion Screw	4
7	Hand shower	1
8	shower hose	1
9	Glove	1
10	Instruction	1
11	Screw tool	1

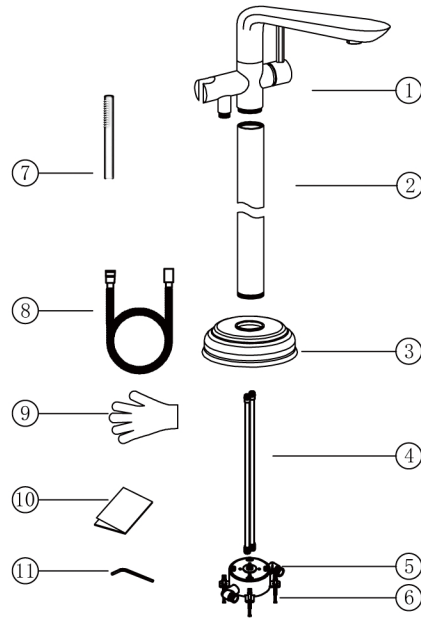

NOTICE:

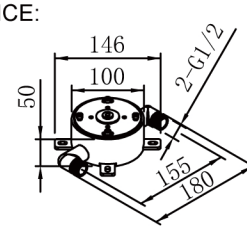

1.N-box in-wall depth: $D \leq 46\text{mm}$,
N-box more than 2mm of tiles.

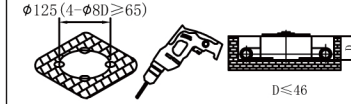

2. Adjust level by gradiometer.
Fix by M6 expansion Screw.

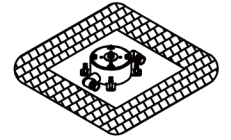

3. Jointing hot and cold water joint. Prevent no leakage.

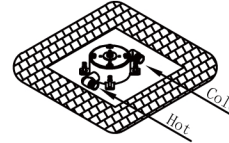

4. Clean.

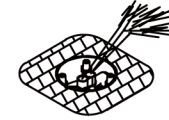

5. Take spare parts, cover, test parts and gradiometer.

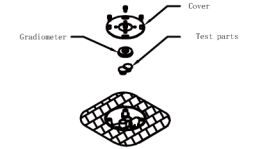

6. Connect body by H8 screw tool.

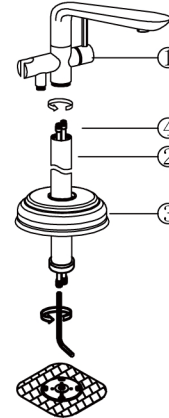

7. Fix panel by M4 screw.

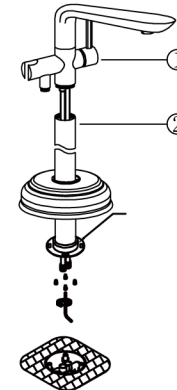

8. Connect control body.

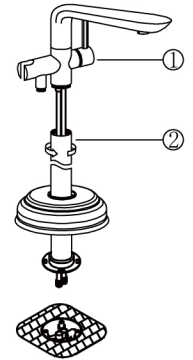

9. Fix pipe in N-box, adjust position, fix panel by M5 screw.

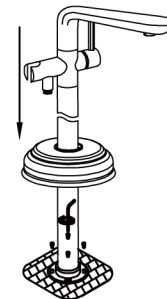

10. Fix shower hose and hand shower.

